

		Conditions	
cell type:		NiMH	
cell size:		AA	
nominal voltage:	1.2	V	
max. charge voltage:	1.5	V	at standard charge (0.1C / 20°C)
capacity			
nominal:	2100	mAh	discharge at 0.2C
minimum:	1900	mAh	discharge at 0.2C
	1750	mAh	discharge at 1C
			1.0V end discharge voltage
			ta: 20°C
max. continuous discharge current:	4200	mA	ta: 0...45°C
charge			
standard charge:	210	mA	14...16hrs
quick charge:	600	mA	4hrs
fast charge:	2100	mA	1.1hrs
recommended charge termination control parameters:	5...10	mV	- delta V
	0.8...1	°C	temperature rise per minute
	45...50	°C	TCO (temperature cut off)
trickle charge current:	21...100	mA	(recommended)
continuous overcharge: (less than 1 year)	≤ 190	mA	no conspicuous deformation no leakage
internal resistance: (impedance)	≤ 40	mΩ	at 1KHz battery fully charged
life expectancy:	≥ 500	cycles	acc. IEC standard
self discharge			
charge retention: (at ≤ 20°C ambient)	≥ 85	%	after 6 months storage
	≥ 80	%	after 12 months storage
initial capacity:	≥ 1500	mAh	within 30 days after delivery discharge at 0.2C
ambient temperature range:	0...45	°C	standard charge
	10...40	°C	fast charge
	- 20...65	°C	discharge (≤1.0C)
	0...45	°C	discharge (>1.0C)
	- 20...50	°C	storage (≤3months)
	- 20...40	°C	storage (≤6months)
	- 20...30	°C	storage (≤24months)
QCT1:	20/1800/35		
QCT2:	30/1700/40		

Diagrams

standard charge

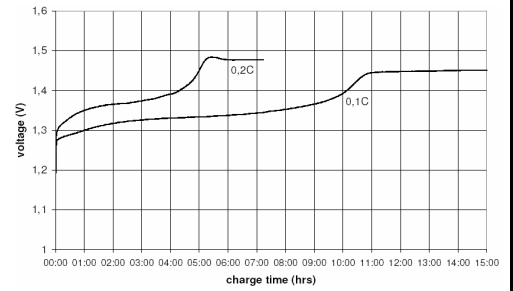

fast charge

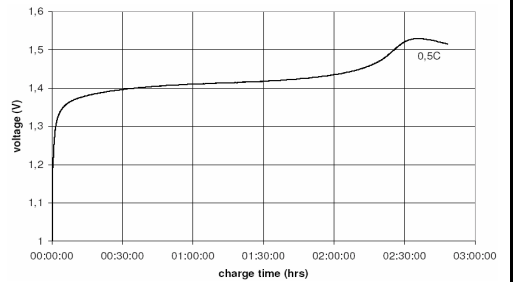

low rate discharge

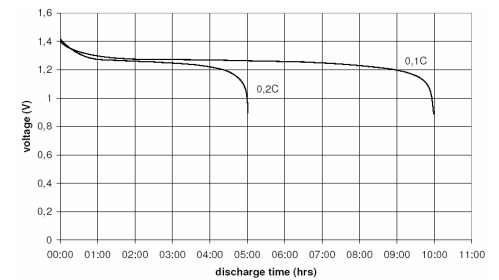

high rate discharge

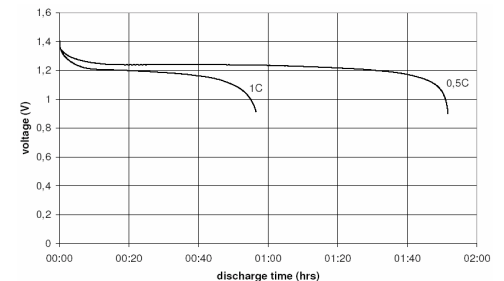

mechanical specifications

cell dimensions (incl. label)

diameter d1:	14.3	- 1.0	mm
diameter d2:	7.5	- 2.0	mm
height h1:	49.5	- 1.5	mm
height h2:	min. 0.3		mm
weight:	28	± 2	g

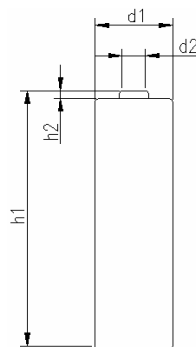

27



ANSMANN Specifications for model:

data sheet no. / part no.

version no.

author / date

AA - 2100mAh low self discharge flat head with tags (z-form)

5035371-01

0

Gramlich /25.06.2010