



PART NO.

MCEI Series

## REVISIONS

ECN #	REV	DESCRIPTION	DRAWN	DATE	CHECKD	DATE	APPRVD	DATE
-	A	RELEASED	Jagan	11/2/08	Suresh	11/2/08	G. C	26/2/08

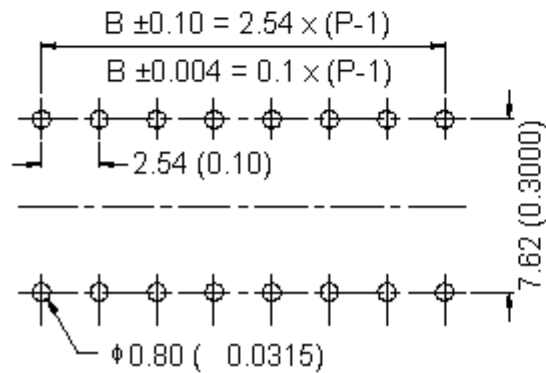
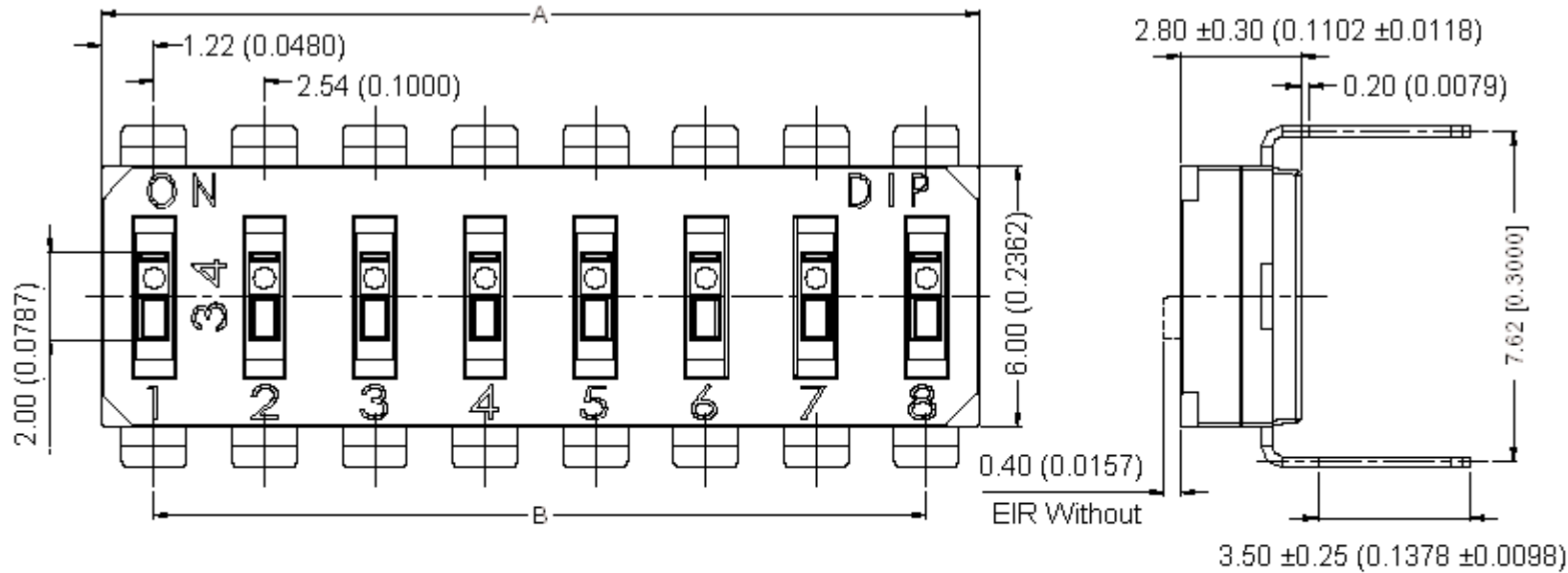

PCB Layout

## Schematic (Typical)

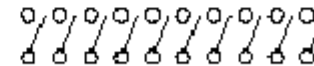

(1, 2, 3, 4, 5, 6, 7, 8, 9, 10, 12 Positions Available)

Dimensions : Millimetres (Inches)

## TOLERANCES:

UNLESS OTHERWISE SPECIFIED, DIMENSIONS ARE FOR REFERENCE PURPOSES ONLY.

## DRAWN BY:

Jagan

## DATE:

11/02/08

## CHECKED BY:

Suresh

## DATE:

11/02/08

## APPROVED BY:

G.Cook

## DATE:

26/02/08

## DRAWING TITLE:

Dual In Line Switches - End Stackable

SIZE  
A

DWG NO.

M10000815

ELECTRONIC FILE  
EI-EIR\_DWGREV  
A

SCALE: NTS

U.O.M.: mm (Inches)

SHEET: 1 OF 5



PART NO.

MCEI Series

## REVISIONS

ECN #	REV	DESCRIPTION	DRAWN	DATE	CHECKD	DATE	APPRVD	DATE
-	A	RELEASED	Jagan	11/2/08	Suresh	11/2/08	G. C	26/2/08

**Specifications:****Mechanical:**

Mechanical life : 2,000 operations.  
Maximum operating force : 1,000gf.  
Stroke : 1.0mm  
Operating temperature range : -20 to +85°C.  
Storage temperature range : -40 to +85°C.

**Electrical:**

Electrical life : 2,000 cycles.  
Rating : 25mA, 24V dc.  
Minimum contact resistance : 100mΩ at 500V dc.  
Maximum insulation resistance : 100MΩ at 500V dc.  
Dielectric strength : 500V ac/1 minute.  
Contact arrangement : 1 pole throw.

**Materials:**

Base and cover : UL 94V-0 Nylon high temperature thermoplastic.  
Colour : Black.  
Actuator : UL 94V-0 LCP high temperature thermoplastic.  
Colour : White.  
Contact : Alloy copper with gold plated.  
Terminal : Brass with gold plated.  
Tape : Kapton.

## TOLERANCES:

UNLESS OTHERWISE  
SPECIFIED,  
DIMENSIONS ARE  
FOR REFERENCE  
PURPOSES ONLY.

DRAWN BY:

Jagan

DATE:

11/02/08

CHECKED BY:

Suresh

DATE:

11/02/08

APPROVED BY:

G.Cook

DATE:

26/02/08

DRAWING TITLE:

Dual In Line Switches - End Stackable

SIZE  
**A**

DWG NO.

**M10000815**ELECTRONIC FILE  
EI-EIR\_DWGREV  
**A**

SCALE: NTS

U.O.M.: mm (Inches)

SHEET: 2 OF 5



PART NO.

MCEI Series

## REVISIONS

ECN #	REV	DESCRIPTION	DRAWN	DATE	CHECKD	DATE	APPRVD	DATE
-	A	RELEASED	Jagan	11/2/08	Suresh	11/2/08	G. C	26/2/08

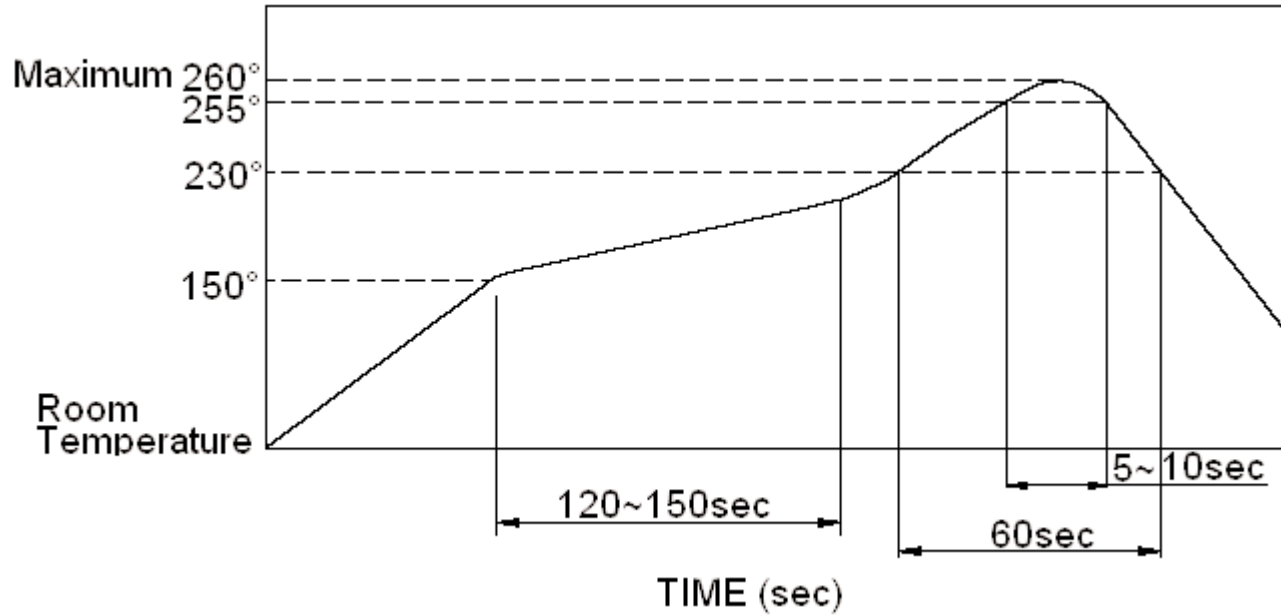

Reflow Temperature Profile

**Soldering Process:****Wave soldering:** Recommended solder temperature at 500°F ( 260°C) maximum of 5 seconds for through hole type.**Hand soldering:** Use a soldering iron of 30 watts, controlled at 350°C approximately maximum 5 seconds while applying.**Reflow soldering:** When applying reflow soldering, the peak temperature or the reflow Oven should be set at 260°C maximum.

Do not wash the switch except top tape sealed type, which suitable for spray cleaning method from top of the s/w.

## TOLERANCES:

UNLESS OTHERWISE  
SPECIFIED,  
DIMENSIONS ARE  
FOR REFERENCE  
PURPOSES ONLY.

DRAWN BY:

Jagan

DATE:

11/02/08

CHECKED BY:

Suresh

DATE:

11/02/08

APPROVED BY:

G.Cook

DATE:

26/02/08

DRAWING TITLE:

Dual In Line Switches - End Stackable

SIZE  
A

DWG NO.

M10000815

ELECTRONIC FILE  
EI-EIR\_DWGREV  
A

SCALE: NTS

U.O.M.: mm (Inches)

SHEET: 3 OF 5



PART NO.

MCEI Series

## REVISIONS

ECN #	REV	DESCRIPTION	DRAWN	DATE	CHECKD	DATE	APPRVD	DATE
-	A	RELEASED	Jagan	11/2/08	Suresh	11/2/08	G. C	26/2/08

## Specification Table

Number of Positions	Dimensions (A)	Dimensions (B)	Part Number
2	4.98 (0.196)	2.54 (0.100)	MCEI-02
3	7.52 (0.296)	5.08 (0.100)	MCEI-03
4	10.06 (0.396)	7.62 (0.300)	MCEI-04
5	12.60 (0.496)	10.16 (0.400)	MCEI-05
6	15.14 (0.596)	12.70 (0.500)	MCEI-06
7	17.68 (0.696)	15.24 (0.600)	MCEI-07
8	20.22 (0.796)	17.78 (0.700)	MCEI-08
9	22.76 (0.896)	20.32 (0.800)	MCEI-09
10	25.3 (0.996)	22.86 (0.900)	MCEI-10
12	3.0.38 (1.196)	27.94 (1.190)	MCEI-12
2	4.98 (0.196)	2.54 (0.100)	MCEIR-02
3	7.52 (0.296)	5.08 (0.100)	MCEIR-03
4	10.06 (0.396)	7.62 (0.300)	MCEIR-04
5	12.60 (0.496)	10.16 (0.400)	MCEIR-05
6	15.14 (0.596)	12.70 (0.500)	MCEIR-06
7	17.68 (0.696)	15.24 (0.600)	MCEIR-07
8	20.22 (0.796)	17.78 (0.700)	MCEIR-08
9	22.76 (0.896)	20.32 (0.800)	MCEIR-09
10	25.3 (0.996)	22.86 (0.900)	MCEIR-10
12	3.0.38 (1.196)	27.94 (1.190)	MCEIR-12

Dimensions : Millimetres (Inches)

## TOLERANCES:

UNLESS OTHERWISE SPECIFIED, DIMENSIONS ARE FOR REFERENCE PURPOSES ONLY.

## DRAWN BY:

Jagan

## DATE:

11/02/08

## CHECKED BY:

Suresh

## DATE:

11/02/08

## APPROVED BY:

G.Cook

## DATE:

26/02/08

## DRAWING TITLE:

Dual In Line Switches - End Stackable

SIZE  
A

DWG NO.

M10000815

ELECTRONIC FILE  
EI-EIR\_DWGREV  
A

SCALE: NTS

U.O.M.: mm (Inches)

SHEET: 4 OF 5



PART NO.

MCEI Series

## REVISIONS

ECN #	REV	DESCRIPTION	DRAWN	DATE	CHECKD	DATE	APPRVD	DATE
-	A	RELEASED	Jagan	11/2/08	Suresh	11/2/08	G. C	26/2/08

## Part Number Explanation:

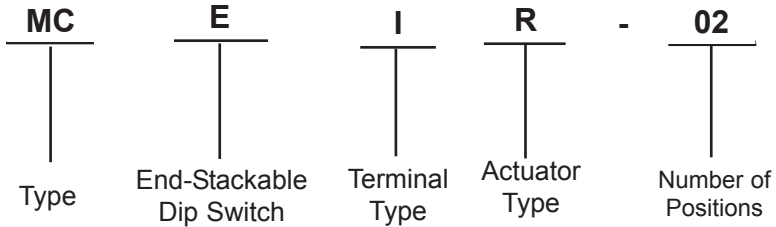

**Terminal Type** : I = Through Hole Type.  
**Actuator Type** : R = Recessed Actuator.  
                          □ = Raised Actuator.  
**Number of Positions** : 02, 03, 04, 05, 06, 07, 08, 09, 10, 12 Positions.

<http://www.farnell.com><http://www.newark.com><http://www.cpc.co.uk>

## TOLERANCES:

UNLESS OTHERWISE  
SPECIFIED,  
DIMENSIONS ARE  
FOR REFERENCE  
PURPOSES ONLY.

DRAWN BY:

Jagan

DATE:

11/02/08

CHECKED BY:

Suresh

DATE:

11/02/08

APPROVED BY:

G.Cook

DATE:

26/02/08

DRAWING TITLE:

Dual In Line Switches - End Stackable

SIZE  
A

DWG NO.

M10000815

ELECTRONIC FILE  
EI-EIR\_DWGREV  
A

SCALE: NTS

U.O.M.: mm (Inches)

SHEET: 5 OF 5