

C2 Emergency Stop Switch **multicomp**

**RoHS
Compliant**



Specifications

Mechanical Life	: >0.25 million operations
Electrical Life	: >0.1 million operations
Rated Insulation Voltage	: 300V
Rated Thermal Current	: 5A
Insulation Resistance	: 100MΩ
Dielectric Strength	: 2,000V AC, 1 minute
Panel Thickness	: 0.8mm to 12mm
Degree of protection	: IP65
Storage Temperature	: -45°C to +85°C
Operating Temperature	: -25°C to +55°C

Contact Ratings (B300/R300)

Rated Insulation Voltage		300V			
Rated Thermal Current		5A			
Operating Voltage		12V	30V	125V	250V
AC	Resistive Load (AC-12)	5A	5A	4A	2A
50/60 Hz	Inductive Load (AC-15)	5A	5A	3A	1.5A
DC	Resistive Load (DC-12)	1A	1A	0.32A	0.16A
	Inductive Load (DC-13)	1A	1A	0.22A	0.11A

Contact Block Mounting Position

Contact			Operator Position	
Configuration	Mounting	Position	Free	Push
10	1	NO		•
	2	-		
20	1	NO		•
	2	NO		•
01	1	NC	•	
	2	-		
02	1	NC	•	
	2	NC	•	
11	1	NO		•
	2	NC	•	

Note

1. There are no → function for 1NO(10) & 2NO(20)

multicomp

C2 Emergency Stop Switch

Emergency Stop Switches

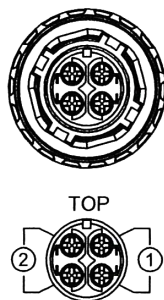
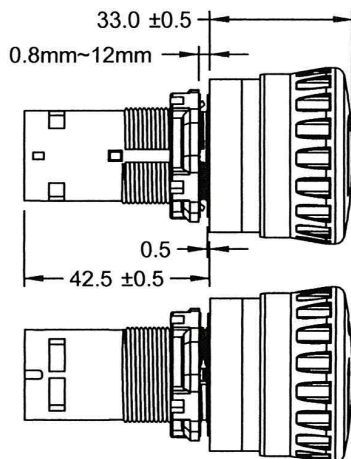

Hole Dia

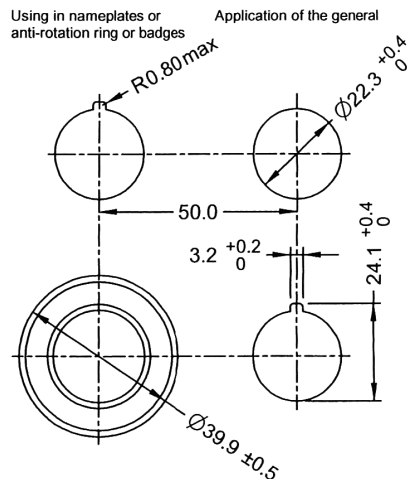

Dimensions : Millimetres

Part Number Explanation

MCC2E

-

BV

E

XX

R

Type

Pull/Turn
to Reset
Mushroom

Standard

Contact

01: 1NC

02: 2NC

10: 1NO

20: 2NO

11: 1NO+1NC

Red

Part Number Table

Description	Part Number
Non-Illuminated Emergency Stop Switch, 40mm, 1NO, Red	MCC2E-BVE10R
Non-Illuminated Emergency Stop Switch, 40mm, 1NC, Red	MCC2E-BVE01R
Non-Illuminated Emergency Stop Switch, 40mm, 2NO, Red	MCC2E-BVE20R
Non-Illuminated Emergency Stop Switch, 40mm, 2NC, Red	MCC2E-BVE02R
Non-Illuminated Emergency Stop Switch, 40mm, 1NO+1NC, Red	MCC2E-BVE11R