

## BUSH data:

SPINDLE VARIATIONS*		BUSH VARIATIONS		
PLASTIC	X (mm)	Y (mm)	W (mm)	Type
Fixed	4	M10 x 0.75	8	Plastic
Fixed	6	M10 x 0.75	8	Plastic
Fixed	6.35	M10 x 0.75	8	Plastic

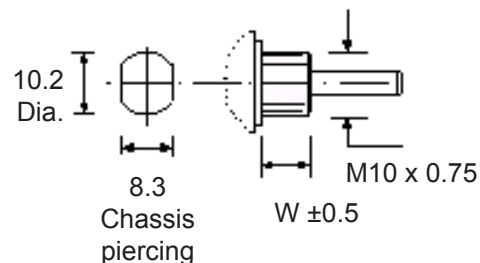

\* Flatted spindles are available.

See E16 ECO Potentiometer 'SPINDLE DATA' leaflet for more information.

**Mechanical and Electrical Specification** - see separate leaflet.

This information is supplied in good faith but the customer is politely reminded that it is their responsibility to check the suitability of our products for their particular application. Please note that all dimensions are for reference purposes only and, as it is the Company's policy to continuously improve our products, we reserve the right to incorporate changes without notice.

**Omeg Ltd.**  
Imberhorne Industrial Estate  
East Grinstead  
West Sussex RH19 1RJ  
ENGLAND  
Tel. +44 (0) 1342 410420 Fax. +44 (0) 1342 316253  
E-mail [sales@omeg.co.uk](mailto:sales@omeg.co.uk)  
<http://www.omeg.co.uk>

Omeg Job No. ....

**TO ORDER** Please complete the following information, photocopy and forward, with your official order, to **Omeg Ltd.**

Omeg Type **PC2G16ECO**

Your Part Reference ..... (If Applicable)

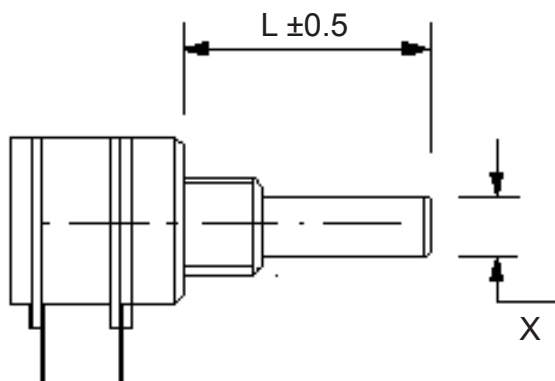

SPINDLE

Plastic Diameter 'X' ..... mm.

\*Cylindrical \*Flat ..... mm.

\*Delete as required

Length 'L' ..... mm. (FML)

BUSH

Plastic Diameter M10 x 0.75

Length 8 mm.

VALUE ..... LAW ..... (Front section - nearest spindle)

VALUE ..... LAW ..... (Rear section)

Special requirements:

Order No. .... Qty. .... Delivery .....

Company .....

Signed ..... (Please print name .....  
.....)

Date .....

**Omeg Ltd.**

Imberhorne Industrial Estate  
East Grinstead  
West Sussex RH19 1RJ  
ENGLAND

Tel. +44 (0) 1342 410420 Fax. +44 (0) 1342 316253

E-mail [sales@omeg.co.uk](mailto:sales@omeg.co.uk)  
<http://www.omeg.co.uk>