

Vinyl Insulated (Easy Entry) Spade Terminal Butted Seam

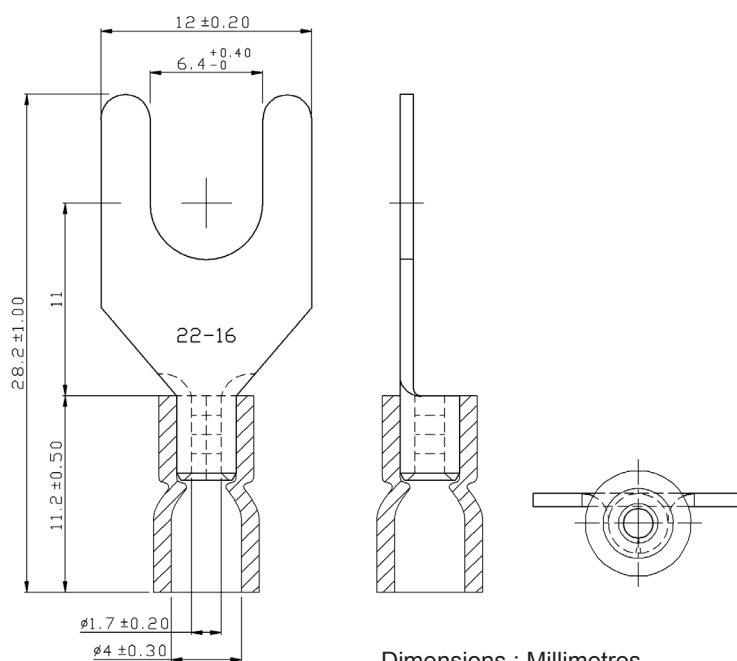

Specifications:

Max. Electric Current	:	AWG	22	20	18	16
	:	AMP.	9	12	17	18
Max. Electrical Rating	:	105°C 600V Max.				
Insulation Material	:	Vinyl				
Insulation Colour	:	Red				
Terminal Material	:	Copper				
Wire Range	:	22AWG to 16AWG (0.5 - 1.5mm ²)				
Terminal Surface Treatment	:	Tin Plated				
Terminal Thickness	:	0.75mm				



Part Number Table

Description	Part Number
Vinyl Insulated (Easy Entry) Spade Terminals; Butted Seam, Red	SVEL1-6

