

5x20mm Semi-enclosed PCB Mounting 22.6mm Pitch Fuseholder



Features:

- PCB mounting
- Fuse retaining insulation cover
- Enclosed contacts
- 22.6mm pitch

Specifications:

Rating	: 6.3A / 250V
Contacts/Resistance Moulding	: Tinned, nickel plated Brass, < 5mΩ
Dielectric strength	: 3kV / 60 Sec
Power dissipation	: 1.6W
Recommended PCB hole size	: 1.5mm
Insulation Resistance	: 100MΩ
Ambient Temperature	: -30°C to +85°C

Diagram

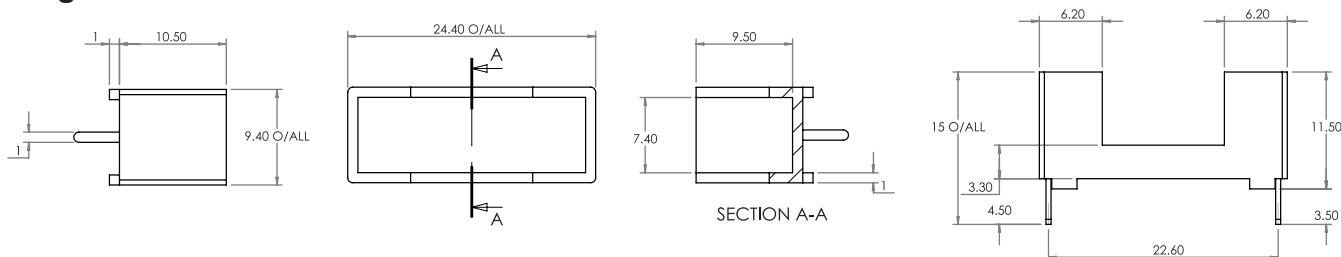

Dimensions : Millimeters
General Tolerances : $\pm 0.3\text{mm}$

Part Number Table

Description	Part Number
5mm × 20mm Semi-enclosed PCB Mounting 22.6mm Pitch Fuseholder w/ Cover	MC000830

