

Enclosed CR2032 Coin Cell Holder with Wire Leads

multicompPRO

**RoHS
Compliant**

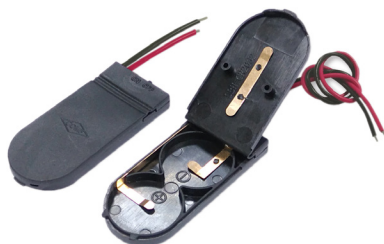

Specifications

Holder Material	: PP3015 Resin, Black colour
Contact Material	: 0.15mm Phosphor Bronze, Natural colour
Wire	: UL1007 AWG 26, Black and Red 150mm \pm 5mm Strip and Tin 5mm \pm 1mm

Diagram

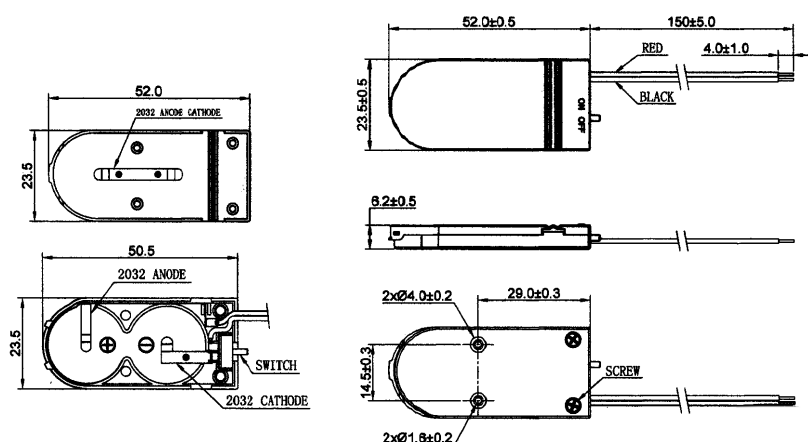

Dimensions : Millimetres

Part Number Table

Description	Part Number
Enclosed Battery Holder, 2 × CR2032, Switched, Wire Leads	MP000384

multicompPRO