

LED Indicators

3mm and 5mm Prominent/Recessed



A range of panel mounting LED indicators in high quality bright chrome or black chrome plated brass housings. Fitted with fixing nut and washer.

Bezel = 4 × 7 diameter (prominent), 3 × 7 diameter (recessed). Total L behind bezel = 11.5 (prominent) 13 (recessed). Mounting hole diameter = 6 Shorter lead Cathode.

Drawing Number - A

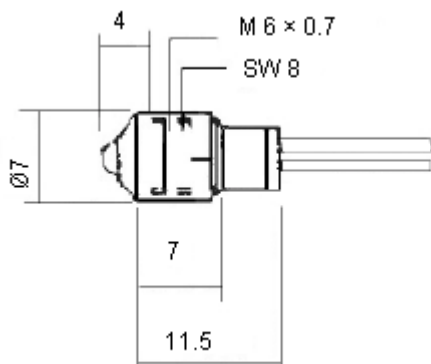

Drawing Number - B

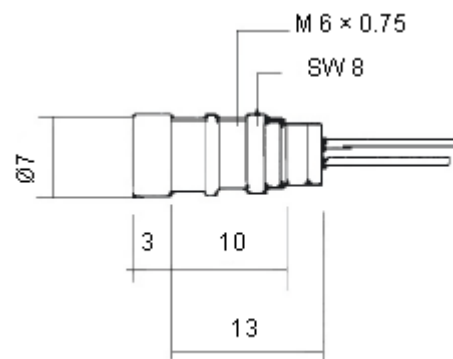

Drawing Number - C

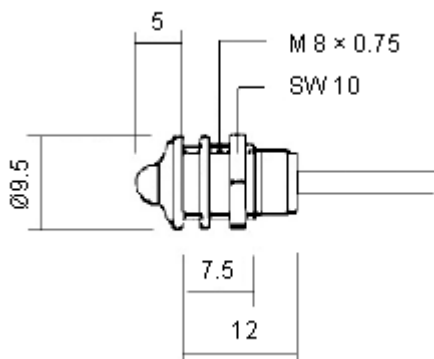

Drawing Number - D

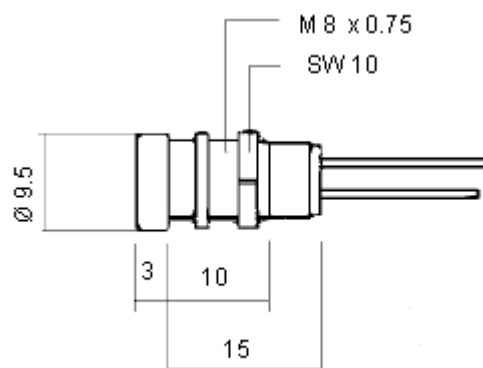

Dimensions : Millimetres