

Straight SMA Jack - Jack Adapter

Description



SMA connectors are semi-precision, subminiature devices that provide repeatable electrical performance from DC to 12.4GHz with flexible cable. Semi-rigid cabling extends the frequency range of the device to 18GHz. These devices offer broadband performance with low reflection and constant 50Ω impedance. These properties, along with minimum attenuation and low VSWR have made the SMA extremely popular in the microwave community.

The SMA design has been broadened to accommodate many interconnect requirements and is available in pressure crimp, clamp and solder terminal attachments. SMA design parameters have incorporated the considerations of balancing cost, size, weight and performance to yield the best value in your microwave system. Among typical applications are components, such as dividers, mixers, amplifiers, trimmers and attenuators. SMA connectors are also used to provide interconnections from printed circuit board strip lines to coaxial cable.

Specifications:

Impedance : 50Ω
Insulation : PTFE
Finish : Gold plated center contact & body

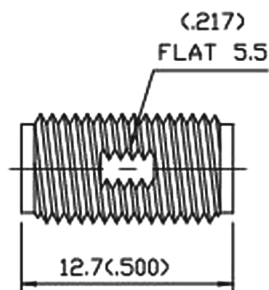

Dimensions : Millimetres (Inches)

Part Number Table

Description	Part Number
Straight SMA Jack - Jack Adapter	19-23-1-TGG