

Inductive Proximity Sensor - 30mm Square Plastic Housing **multicomp**PRO

**RoHS
Compliant**



Features

- Inductive sensor, style: squared shape, 30mm × 30mm × 53mm
- Mounting distance: 15mm shielded
- With LED operation indicate lamp, easily identifiable
- Standard sensing object: ferrous metals
- Protection rate: IP67, water resistant
- Over-current and short circuit protection; against polarity reversal.
- Widely applied in measuring, Counting, Rpm measuring in mechanism, chemical, paper manufacture light industry, etc.

Specifications

Mounting Distance	: 15mm shielded
Sensing Distance	: 13.5mm shielded
Power Supply	: 10V DC to 30V DC/ 90V AC to 250V AC
Frequency	: 300Hz/150Hz (DC 3/2 wires) / 25Hz (AC 2 wires)
Current Output (DC/AC)	: 200mA / 300mA
Ambient Temperature	: -15°C to 70°C
Against Polarity Reversal	: Yes
Short Circuit Protected	: 3 wires: Yes / 2 wires: No
IP Rating	: IP67

Electrical Connection

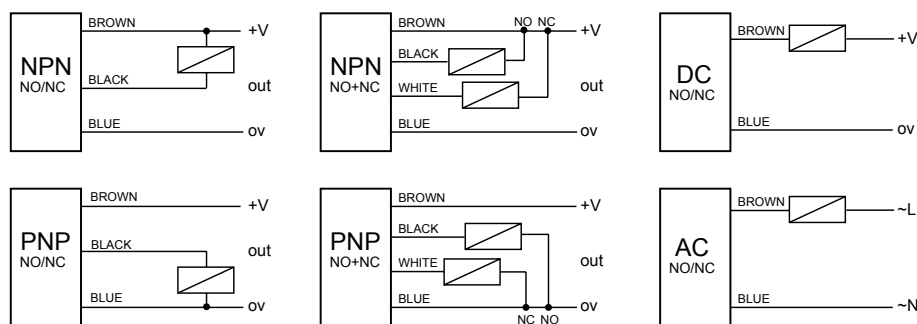

Picture of Product

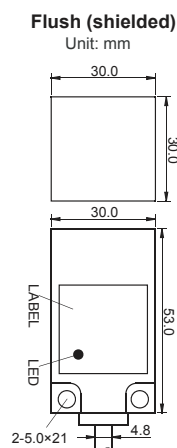

multicompPRO

Inductive Proximity Sensor - 30mm Square Plastic Housing **multicomp**PRO

Installation

If used in an area surrounded by metal, Install the proximity Sensor as follows . (S_n = Sensing distance)

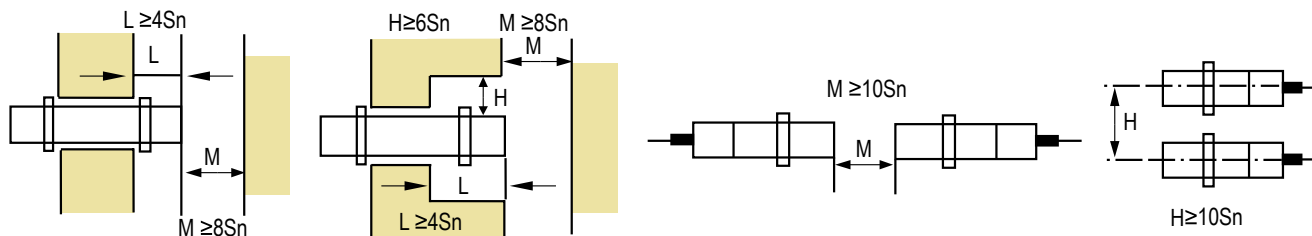

Inductive Proximity Application Direction

- Set mounting distance equal to 80% of S_n .
- Set mounting distance roughly equal to 50% of S_n when sensor is used measuring mounting frequency or operating in high speed circumstances.
- Mounting distance will change depending on material (iron, stainless steel, brass, copper and aluminium).

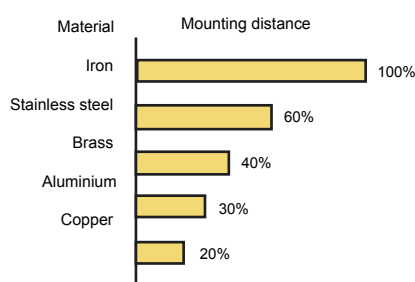
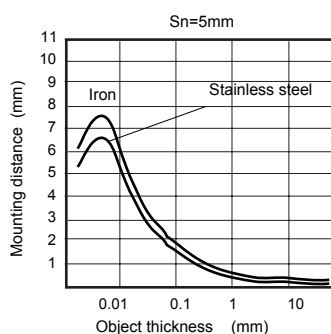
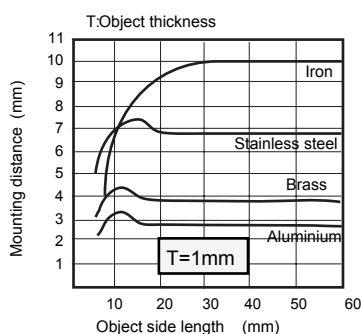

- Ips series connection and parallel connection.

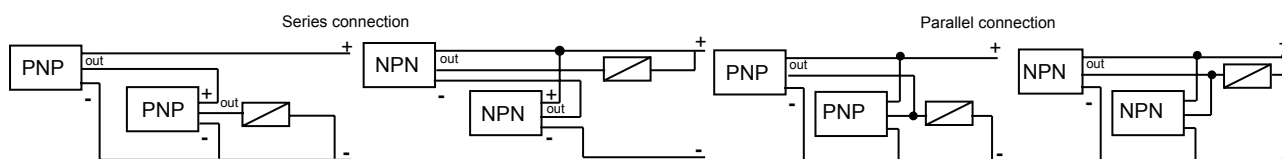

Inductive Proximity Sensor - 30mm Square Plastic Housing **multicomp**^{PRO}

Part Number Table

Part Number	Output Type	Mounting Distance	Current Output	Power Supply	Wire Connector
MP002249	NPN NO	15mm Shielded	200mA	10V DC to 30V DC	3 Wire
MP002250	NPN NC				3 Wire
MP002251	NPN NO + NC				4 Wire
MP002252	PNP NO				3 Wire
MP002253	PNP NC				3 Wire
MP002254	PNP NO + NC				4 Wire
MP002255	DC NO		300mA	90V AC to 250V AC	2 Wire
MP002256	DC NC				
MP002257	AC NO				
MP002258	AC NC				

multicomp^{PRO}